

Own the Milling Factory today



ABOUT



- Mill Complex with the territory and buildings in Cahul, Moldova
- Basic production capacity: 1.5 million kg of wheat flour/month
- Investment recovery plan:

NET PROFIT 0,1 EUR x 1kg = 1 500 000 EUR

Total recovery in the first year of active sales only from basic production

- Additional production: Wheat Bran, Corn flour, Corn Starch, Sunflower Oil and Cake, Oil blending admixture and hydrating, Mayonnaise, Ketchup, Artificial honey, and Feed admixtures on a total 1000+ products

- For net cost and cheapest raw materials grains, we invested in Farming and established strong connections with the growers.
- The complex is equipped with the most modern automated machinery and is operated by a professional working team.
- We have a large client base and export experience.

ADVANTAGES

Mill Complex with the territory and buildings in Cahul, Moldova includes:

6 floors, ten warehouses, transformer, admin building, warehouses, paved territory, weights, and additional free territories.

Strategic location: only 15 km from the boarder with Romania and 60 km from the Port, enables easy access to EU and international markets.



EXPORT EXPERIENCE

- Export Experience and quality approved to Europe, Africa, Arab countries, and Asia.
- Trademark included.
- Returning clients in Indonesia, Turkey, United Arab Emirates, and Central African countries (Angola, Zimbabwe, etc.)



www.inhazar.ro

A 658 AD

DON'T MISS YOUR CHANCE!



FACTORY SALE COST

**Only
2 Million
Euros**

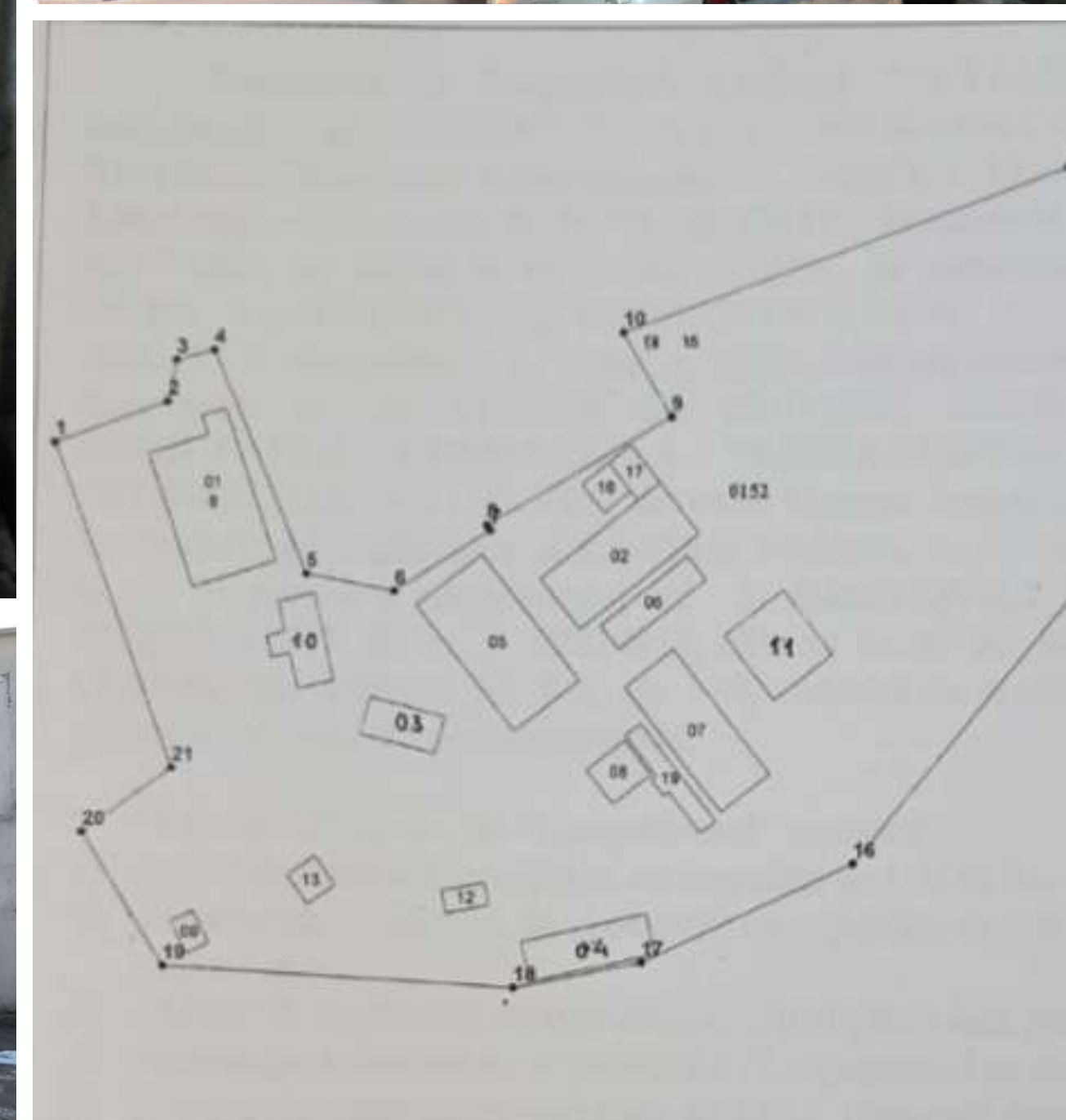

Scara : 1:1500



✉ Info@WorldProNet.com

🌐 www.WorldProNet.com

📍 Eliezer Ben Yehuda 20/1, Rehovot, Israel

Lifting the limits ®